

# Switch Fibre Channel Fault Alarm

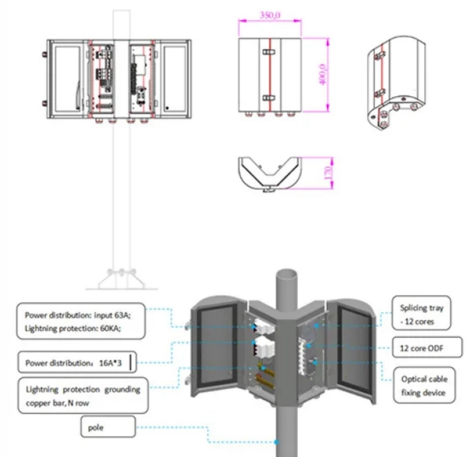

## Overview

Check the controller port status for Tx value is good, replace SFP if Tx signal power is low. Replace FC cable if SFP Tx power is normal for both FC end side, but SFP Rx power is low. This document describes how to troubleshoot fiber optic interfaces by addressing some of the fiber optic module and cabling specifications. The information in this document is based on all Catalyst 9000 Series switches. This includes Doppler. A Fibre Channel link failure may cause service interruption and data loss between the application server and the storage system. On the system page, click to display the rear view. On the rear view of the storage device, click the interface module in. [Node1: fct\_tpd\_work\_thread\_0: scsitarget. [Node1:. Use the following guidelines and suggested steps to help resolve Fibre Channel switch onboarding issues.



## Article Content

Mar 01, 2026

fibre channel

Explore related questions storage-area-network fibre-channel See similar questions with these tags.

Dec 21, 2025

EMS reports Link break detected on FC port due to faulty storage end ...

Reseat the cable/sfp on storage and switch port. Perform end to end cable testing including the patch panel, replace the cable if its faulty. If cable is not faulty, replace the SFP at switch end first as Tx

Nov 27, 2025

Fibre Channel Link Failure

Check whether the rate of the Fibre Channel HBA on the application server is the same as that of the switch port connecting to the application server. If yes, keep the fault environment intact and contact

Sep 28, 2025

Full Fibre (Fibre to the Home): Check your wiring and set-up

Full Fibre (Fibre to the Home): Check your wiring and set-up If you're having trouble with your broadband connection there are a few simple checks that could fix the problem straight away, saving

Mar 25, 2026

Fault Fiber Channels on the host

Issue Description Fault Fiber Channels on the host alarm description from Fusionsphere:

host\_id=C0AFED3C-61A9-XXX,hostname=3CBSCNA07XXXX,error\_info=The Fibre Channel that all

Jul 29, 2025

My full fibre broadband and/or WiFi has stopped

My full fibre broadband and/or WiFi has stopped working, what can I do? Experiencing an outage or no internet connection? For all broadband

Jul 08, 2025

Q-Logic Fibre Channel Switch User Manual

You can configure the switch to generate alarms for selected events. Configuring an alarm involves choosing an event type, rising and falling triggers, a sample window, and finally enabling or disabling

Nov 15, 2025

Link break detected on Fibre Channel target HBA due to faulty cable

Check the SFP status of connected switch port, replace the SFP if switch port Tx power is low. Replace FC cable if SFP Tx power is normal for both FC end side, but SFP Rx power is low for any side.

May 01, 2026

Troubleshooting Fibre Channel switch onboarding issues

Use the following guidelines and suggested steps to help resolve Fibre Channel switch onboarding issues.

Aug 30, 2025

How should I set up my Fibre Channel (FC) network?

In fact, the Fibre Channel protocol is a direct extension of the SCSI protocol. All SCSI commands have a FC equivalent, and FC has a few extra ones that allow for networking. Assuming you have all the

Nov 16, 2025

Device overview

The device along with IMD locates the first fault and signals fault as alarm. IMD monitors the insulation resistance of the system by injecting a signal. This technique is used for all power system types - AC,

Apr 08, 2026

List of Available Alarms

The loss of signal alarm is generated with the default severity Warning when the first event is received. After 60 and 120 minutes, the severity level of this alarm is escalated to Major and Critical respectively.

Aug 12, 2025

Enabling SNMP on Fibre Channel Switches

We have a pair of MDS 9132T FC Switches and we are trying to find where to enable SNMP so that we can add monitoring of ports and system health to our PRTG Monitoring System.

Nov 11, 2025

What is a Fibre Channel switch? | Definition from

A Fibre Channel (FC) switch is a networking device that's compatible with the FC protocol and designed for use in a dedicated storage area network

Aug 30, 2025

Cisco Embedded Service 2020 Series Software Configuration Guide Cisco ...

Port Status Monitoring Alarms The switch can also monitor the status of the Ethernet ports and generate alarm messages based on the alarms listed in Table 3-2. To save user time and

Aug 30, 2025

Local Fault and Remote Fault in Ethernet Standards

Conclusion Ethernet's Local Fault and Remote Fault messages are simple yet informative tools for troubleshooting physical layer issues in Ethernet networks.

Oct 11, 2025

What are the Common Client Level Alarms on Optical

There are several causes of client level alarms on optical devices. These include: Fiber Optic Cable Issues Fiber optic cables can be damaged by a

Oct 09, 2025

Troubleshoot Fiber Links on Catalyst 9000 Series Switches

This document describes how to troubleshoot fiber optic interfaces by addressing some of the fiber optic module and cabling specifications.

Apr 11, 2026

Tips and Best Practices for Managing Fibre Channel Switches

Learn how to configure, monitor, secure, troubleshoot, and learn from Fibre Channel switches in this article. Improve your network performance and reliability with Fibre Channel technology.

Jul 22, 2025

Fibre Channel switch

Fibre Channel switches may be deployed one at a time or in larger multi-switch configurations. SAN administrators typically add new switches as their server and storage needs grow, connecting

Dec 29, 2025

Q-Logic Fibre Channel Switch User Manual

The following fault messages apply only to SANbox 9000 series switches. Fault events, like alarms, require administrator attention and may require assistance from your authorized maintenance provider.

Aug 25, 2025

CRC errors in Fiber connection interface

Normally you try swapping out one thing at a time to you narrow it down to one thing that has the fault. A low power alarm could also been the fibre is too long, is of a low grade, or is poorly

Jun 19, 2026

Fibre Channel Switch Monitoring

In the computer storage field, a Fibre Channel switch is a network switch compatible with the Fibre Channel (FC) protocol. It allows the creation of a Fibre Channel fabric, that is currently the core

Aug 03, 2025

Qlogic Fibre Channel Switch Event Message Manual

View and Download Qlogic Fibre Channel Switch event message manual online. Firmware Version 5.0. QLogic Fibre Channel Switch switch pdf manual download.

Jul 14, 2025

Design a Reliable and Highly Available Fibre Channel SAN

What You Will Learn This document explains how to design highly available Fibre Channel networks. Such a design requires switches with an appropriate hardware design architecture, a solid software

May 24, 2026

Qlogic Fibre Channel Switch Event Message Manual

Introduction This manual describes the alarm messages for QLogic Fibre Channel switches. This manual is organized as follows: Section 1 describes the intended audience, related materials, and

Dec 15, 2025

The fine art of Fibre Channel troubleshooting

Troubleshooting Fibre Channel networks can be as much an art as it is a science, but there are some basic best practices you can follow to reduce the guessing and speed resolution.

Oct 10, 2025

## Fiber Optic Troubleshooting: Expert Guide for Common

Troubleshoot fiber optic issues like a pro with our expert guide. Resolve common problems and ensure seamless connectivity.

Mar 19, 2026

### Connectrix: How to troubleshoot Fibre Channel node to switch ...

This article explains how to troubleshoot Fibre Channel node to switch port or SFP communication problems by elimination.

## Contact Us

For more information, pricing, or custom solutions, please contact us:

Website: <https://moletenare-ew.co.za>

Email: [info@moletenare-ew.co.za](mailto:info@moletenare-ew.co.za)

Phone: +86 138 1658 3346

Address: Ningbo, China

This document is for informational purposes only. Specifications subject to change without notice.

